

SHOCK ABSORBERS

INSTALLATION GUIDE



1. Always follow the application code of each shock absorber.

2. Never hold a shock absorber by its stem while assembling it onto or disassembling it from your car. Instead you should hold it by its embedded hexagons using special tools.

 **Please remember that the stem is the most important component of a shock absorber.**

3. Apply the appropriate torque according to the car manufacturer's recommendations to fix the shock absorber onto the chassis. This guarantees not only the useful life of the pads, but also the mechanical strength of the assembly pins.

4. After installing a new shock absorber, you should check the tire alignment and balancing following the car manufacturer's instructions, especially for McPherson suspensions.

Check the condition of the original accessories. They have to be replaced if they are in bad shape.

Proper operation depends on the correct installation of accessories. Otherwise, there will be a decrease in the useful life of all suspension parts.

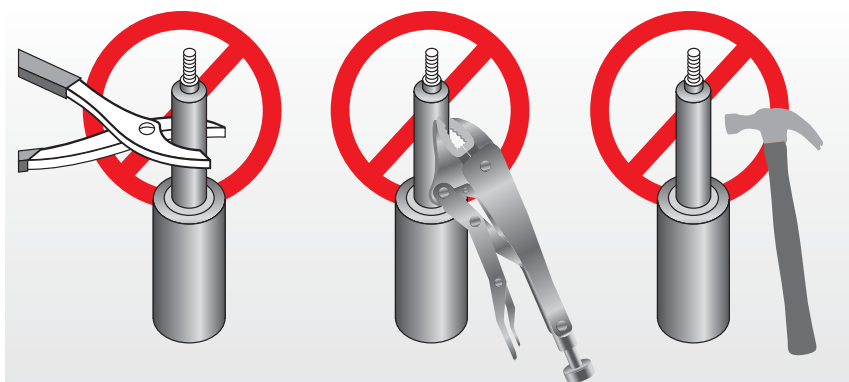

INCORRECT USE

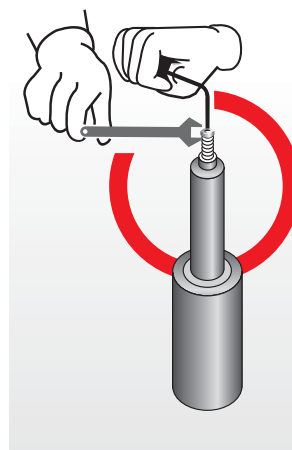

CORRECT USE

STANDARD SHOCK ABSORBERS

REMOVAL AND FITMENT OF SHOCKS



REMOVAL OF SHOCKS

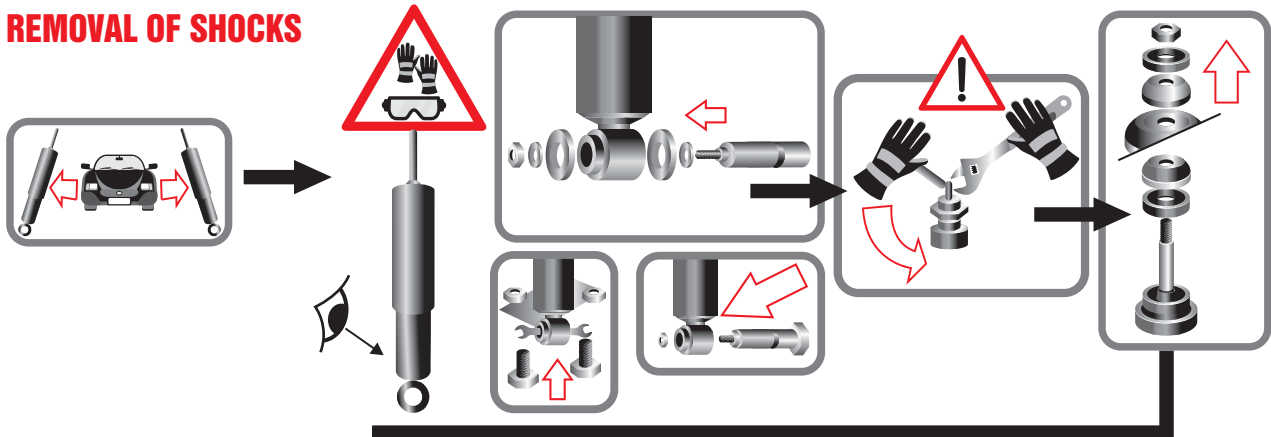

DISPOSAL OF SHOCKS

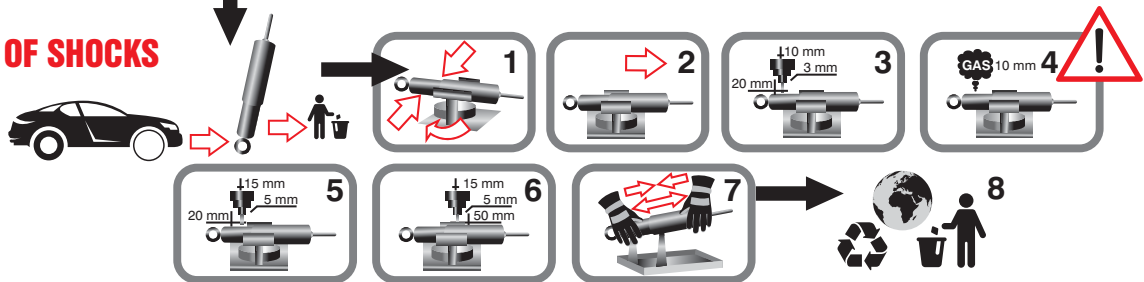

FITMENT OF SHOCK

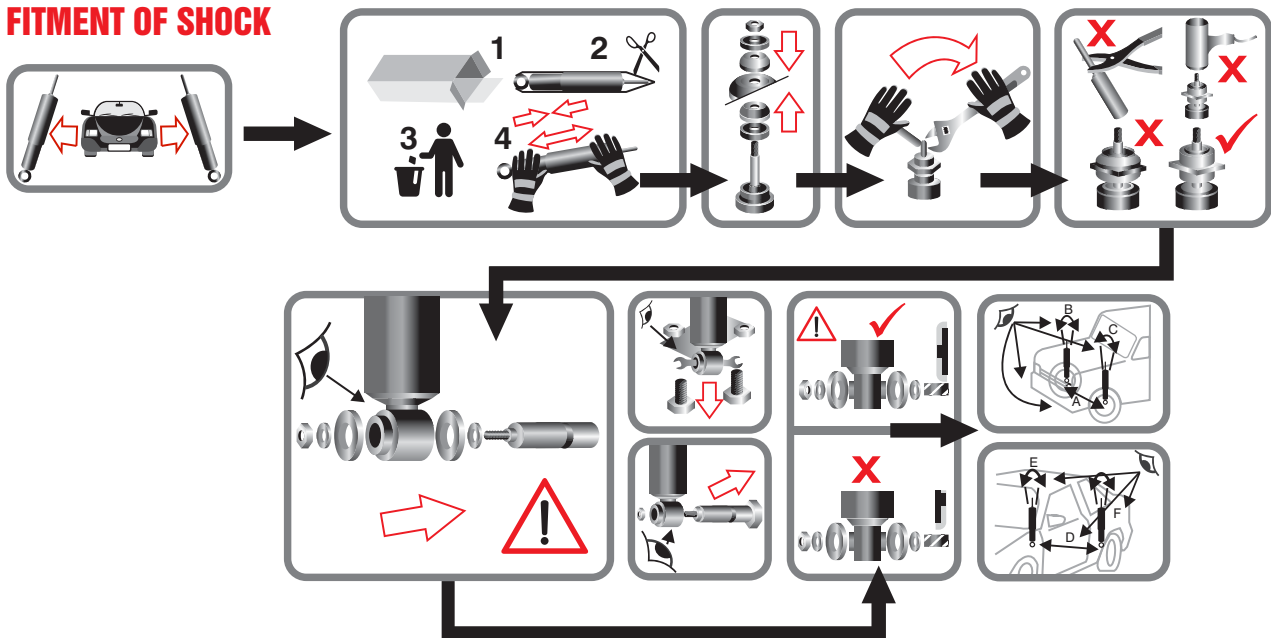

SHOCK ABSORBER STRUTS

REMOVAL AND FITMENT OF STRUTS



REMOVAL OF STRUTS

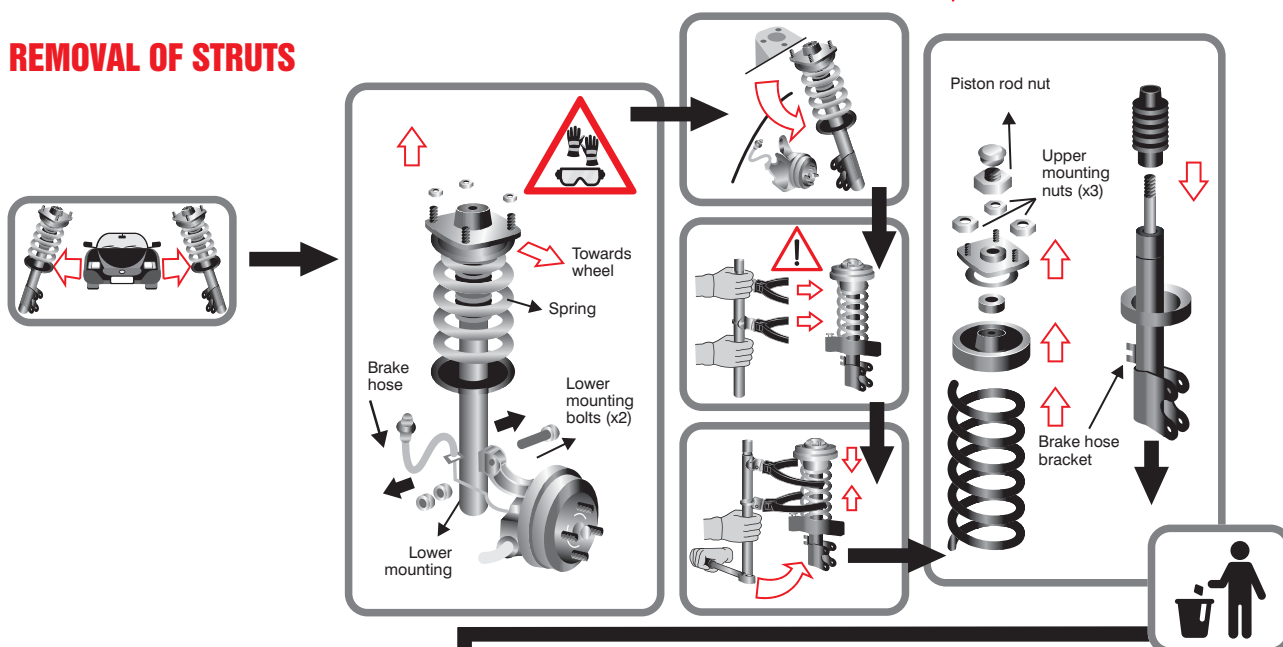

DISPOSAL OF STRUTS

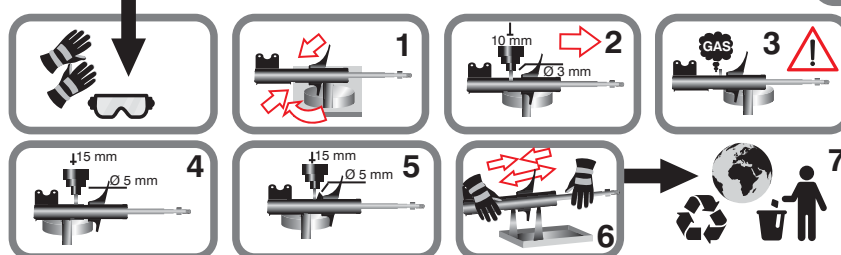

FITMENT OF STRUTS

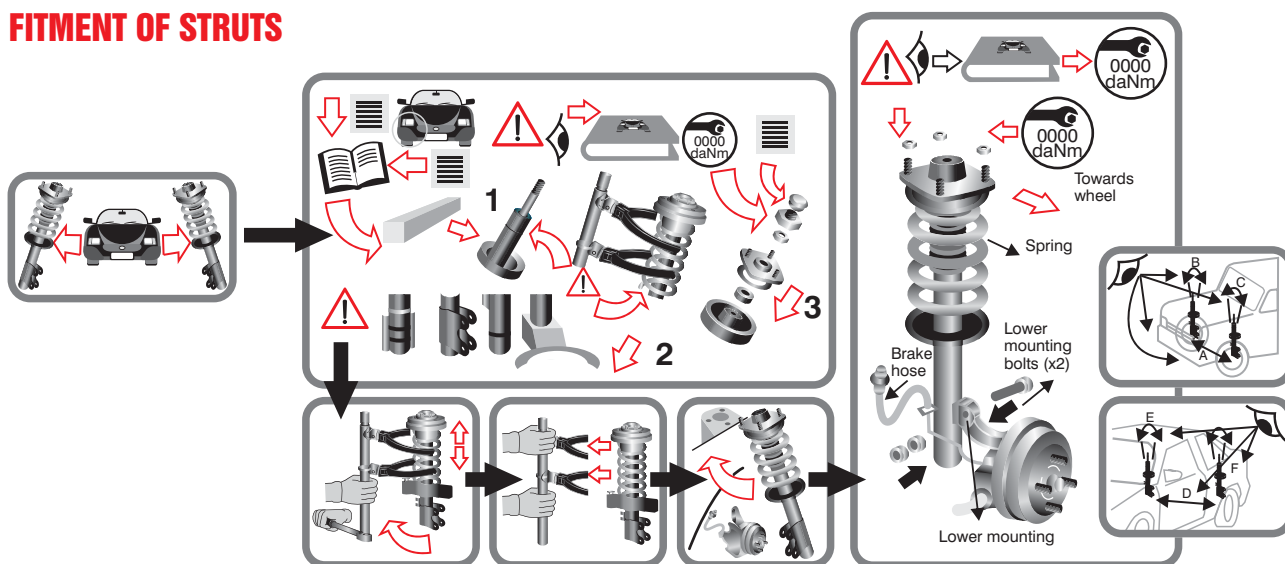

SHOCK ABSORBERS

ASSEMBLY ILLUSTRATION



SHOULDERED STEM

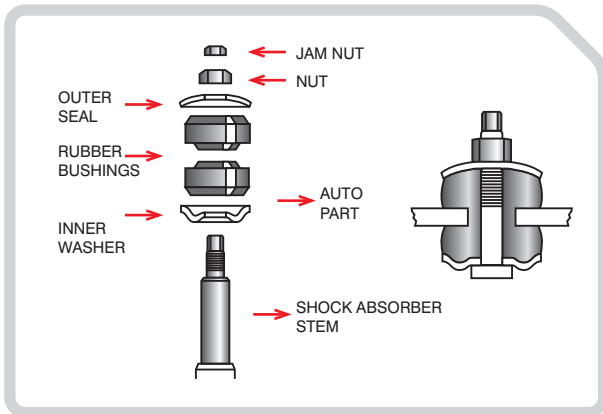

ASSEMBLY USING A CROSSED PIN

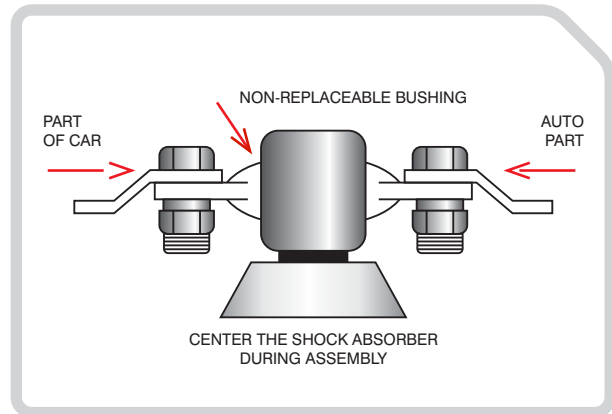

ASSEMBLY WITHOUT AN INNER GLAND

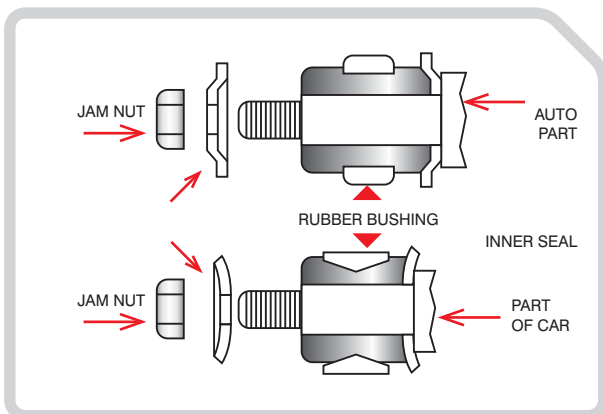

ASSEMBLY USING AN INNER GLAND

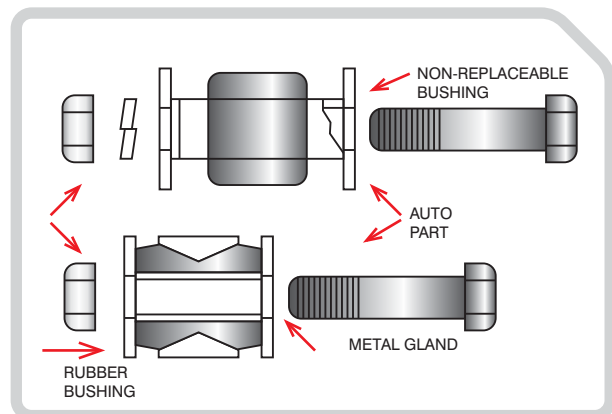

WARNING



Do not open or heat up the shock absorbers, as the housing could crack open, spilling oil. To remove oil and gas from discarded or defective

shock absorbers, some protection measures should be taken. These include wearing safety goggles and protective gloves.